

Previous Design

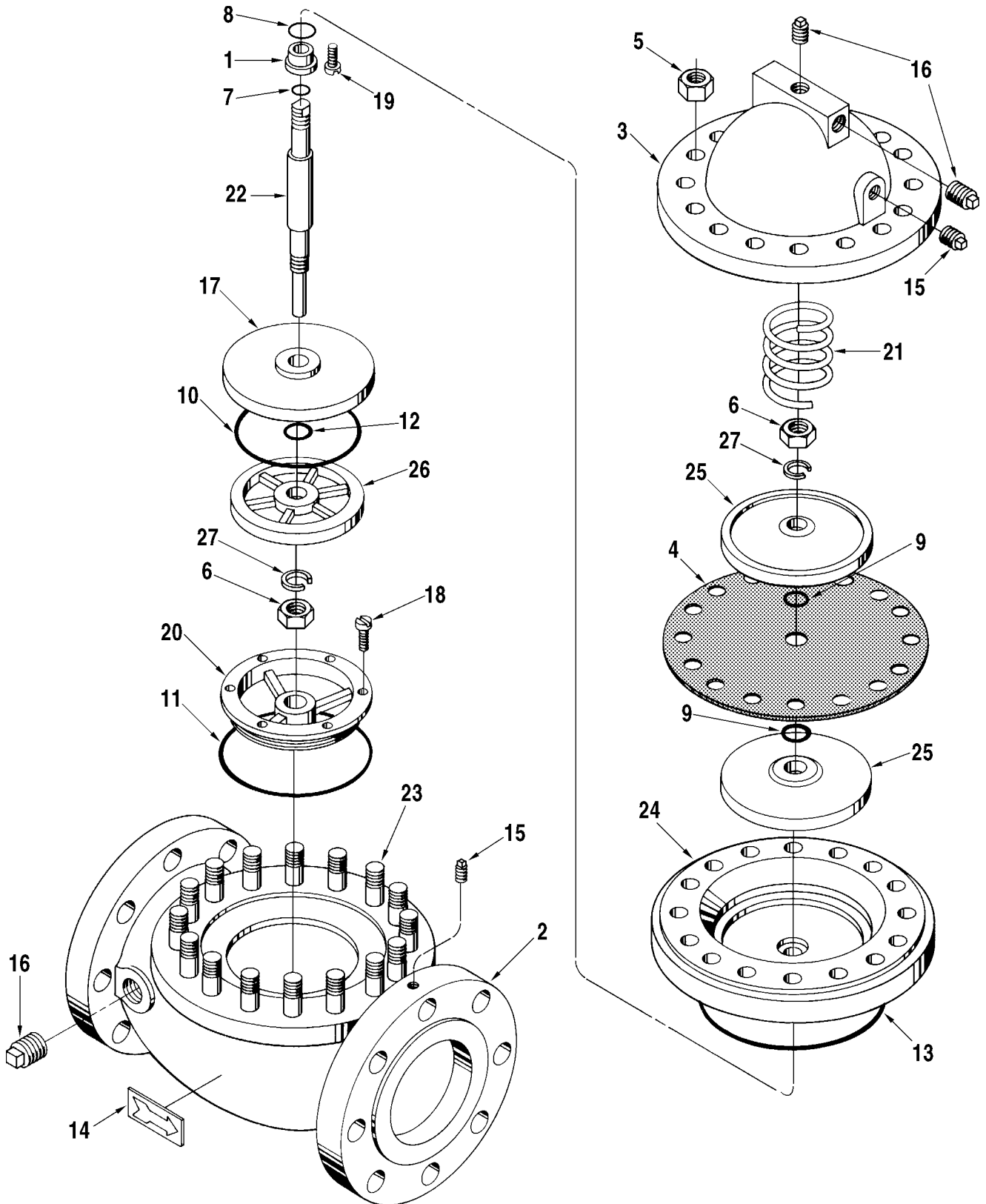

Item	Description	Qty.	Current Design*	Previous Design
1	Bearing, Stem.....	1	528389-001	528389-001
2	@1 Body:			
	Standard - 150 lb.....	1	529654-008	528973-007
	Standard - 300 lb.....	1	529654-010	528973-008
	Lo-Temp. - 150 lb.....	1	529654-009
	Lo-Temp. - 300 lb.....	1	529654-011
3	@1 Cover:			
	Standard.....	1	529653-001	528972-001
	Lo-Temp.....	1	529653-003
4	+@1 Diaphragm:			
	Buna-N.....	1	529656-001	507404-001
	Viton.....	1	529656-002	507404-002
5	@1 Nut, Cover:			
	7/8"-9.....	18	645201-406
	3/4"-10.....	16	642138-406
6	Nut, Stem, 1-1/8"-12.....	2	640819-408	640819-408
7	+ O-Ring, Bearing:			
	Buna-N.....	1	640888-010	640888-010
	Viton.....	1	640894-412	640894-412
8	+ O-Ring, Bearing:			
	Buna-N.....	1	640685-014	640685-014
	Viton.....	1	640798-438	640798-438
9	+ O-Ring, Diaphragm:			
	Buna-N.....	2	640887-015	640887-015
	Viton.....	2	640798-424	640798-424
10	+ O-Ring, Retainer:			
	Buna-N.....	1	507576-001	507576-001
	Viton.....	1	507576-003	507576-003
11	+ O-Ring, Seat:			
	Buna-N.....	1	641070-432	641070-432
	Viton.....	1	641276-431	641276-431
12	+ O-Ring, Stem:			
	Buna-N.....	1	640887-015	640887-015
	Viton.....	1	640798-424	640798-424
13	+ O-Ring, Wafer:			
	Buna-N.....	1	641069-471	641069-471
	Viton.....	1	640894-450	640894-450
14	Plate, Arrow Flow.....	1	508553-001	508553-001
15	Plug, Pipe:			
	Standard - 1/8" NPT.....	3	006073-002	006073-002
	Lo-Temp. - 1/8" NPT.....	3	640820-402
16	Plug, Pipe:			
	Standard - 3/4" NPT.....	7	006878-002	006878-002
	Lo-Temp. - 3/4" NPT.....	7	640820-405
17	Retainer, O-Ring.....	1	507713-002	507713-002
18	Screw, #10-32 x 1/2".....	6	643923-401	643923-401
19	Screw, Truss Head, 1/4-20 x 3/8".....	2	644278-401	644278-401
20	Seat:			
	Standard.....	1	529212-001	529212-001
	Lo-Temp.....	1	529212-002
21	Spring.....	1	525356-001	525356-001
22	Stem.....	1	529222-002	529222-001
23	@1 Stud:			
	Standard - 7/8"-9.....	18	643082-408
	Standard - 3/4"-10.....	16	640528-405
	Lo-Temp. - 7/8"-9.....	18	645868-402

Item	Description	Qty.	Current Design*	Previous Design
24	@1 Wafer, Insert:			
	Standard	1	529684-001	528387-001
	Lo-Temp.	1	529684-003
25	Washer, Diaphragm	2	508001-003	508001-003
26	Washer, O-Ring	1	508041-003	508041-003
27	Washer, Stem	2	643164-408	643164-408

+ Recommended stock.

*@1 As of November 1991, the current design valve incorporates 18 body studs (Item 23) and corresponding number of cover and diaphragm holes. Current design also incorporates Alberta Boiler Branch, Canadian registration.

The specifications contained herein are subject to change without notice and any user of said specifications should verify from the manufacturer that the specifications are currently in effect. Otherwise, the manufacturer assumes no responsibility for the use of specifications which may have been changed and are no longer in effect.

Headquarters:

1803 Gears Road, Houston, TX 77067 USA, Phone: 281/260-2190, Fax: 281/260-2191

Gas Measurement Products:

Erie, PA USA Phone 814/898-5000
 Thetford, England Phone (44) 1842-82-2900
 Kongsberg, Norway Phone (47) 32/286-700
 Buenos Aires, Argentina Phone 54 (11) 4312-4736

Integrated Measurement Systems:

Corpus Christi, TX USA Phone 361/289-3400
 Kongsberg, Norway Phone (47) 32/286-700
 San Juan, Puerto Rico Phone 787/274-3760
 United Arab Emirates, Dubai Phone 971 +4/331-3646

Liquid Measurement Products:

Erie, PA USA Phone 814/898-5000
 Los Angeles, CA USA Phone 661/702-8660
 Slough, England Phone (44) 1753-57-1515
 Ellerbek, Germany Phone (49) 4101-3040
 Barcelona, Spain Phone (34) 93/201-0989
 Moscow, Russia Phone (7) 495/564-8705
 Melbourne, Australia Phone (61) 3/9807-2818

Beijing, China Phone (86) 10/6500-2251
 Singapore Phone (65) 6861-3011
 Chennai, India Phone (91) 44/450-4400

Visit our website at www.fmctechnologies.com