

Inner Mechanism

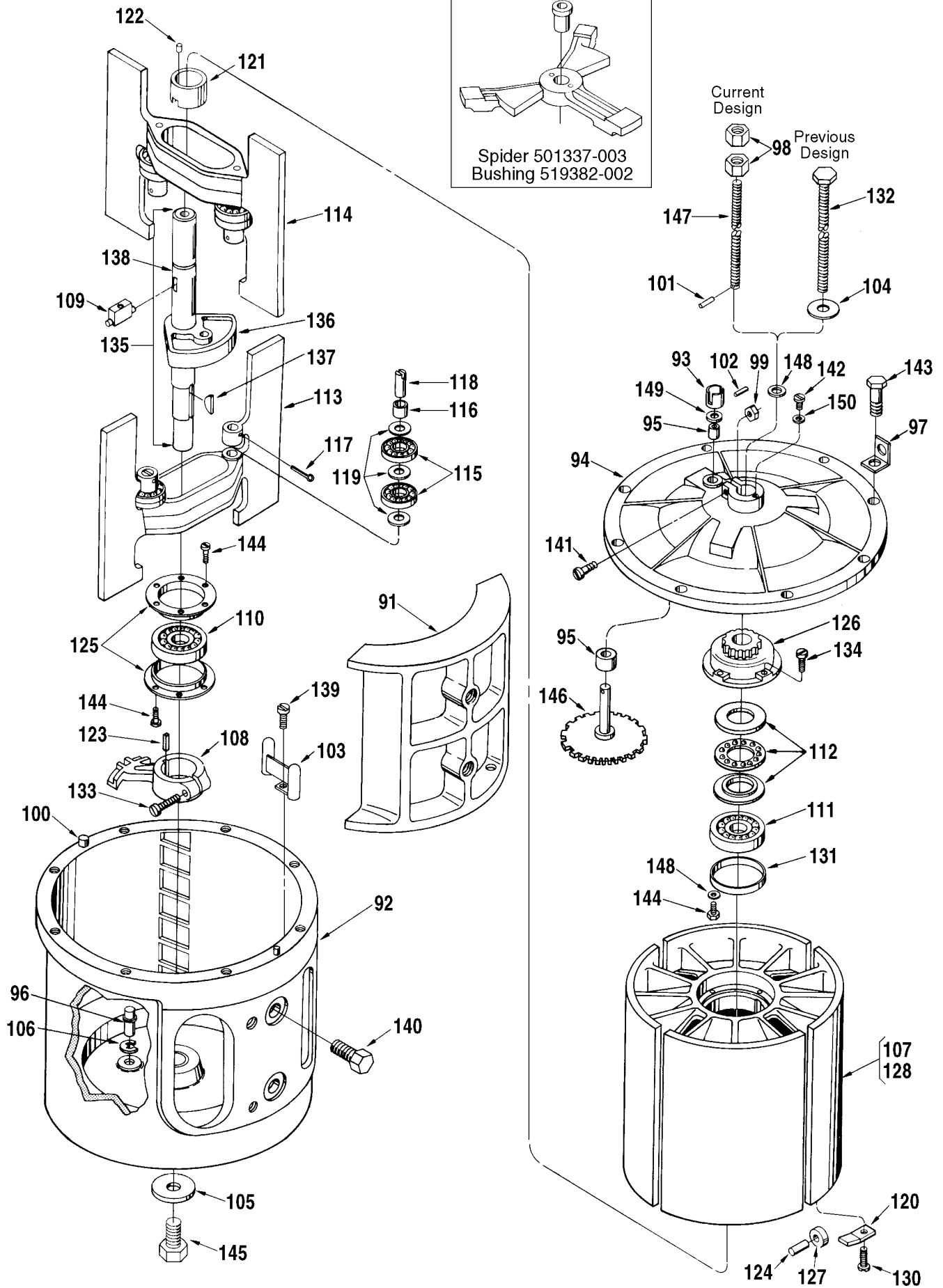

Item	Description	Qty.	H8-S1	H8-S3, S5	H8-S6, S7
1	Adapter	1	518350-001	511946-001	515755-001
2	Adapter, Calibrator Adjusting Stem.....	1	512372-001	512372-001	512372-001
3	Blank.....	1	015533-401
4	+ Calibrator:				
	Dummy.....	1	516105-001	516105-001	516105-001
	Standard.....	1	512059-001	512059-001	512059-001
	Temperature Corrected, Standard.....	1	512060-001	512060-001	512060-001
	@1 Temperature Corrected, Special Temp. or API ...	1	516130-	516130-	516130-
5	Cap:				
	Standard.....	1	641746-401
	NACE	1	645238-401
6	Clamp, Oil Tube	1	003905-001	003905-001	003905-001
7	+ Coupling, Drive	1	072103-001	072103-001	072103-001
8	Coupling, Drive:				
	S6.....	1	518321-003
	S7.....	1	518321-006
9	Coupling, Input.....	1	014356-001	003821-001	005969-001
10	Coupling, Jackshaft	1	514633-001	514633-001
11	Cover Assembly, Outer:				
	S7 Only	1	515924-001
	All Others, Standard.....	1	513051-001	513628-091	516046-001
	NACE	1	552486-001	551661-001
12	Bushing.....	1	519882-002
13	Pin, Groove, 3/16 x 3/8".....	2	641007-401
14	Shaft, Calibrator Drive Gear	1	003775-001
15	Shaft, Idler Pinion Gear	1	512077-001
16	Cover, Knob	1	003553-001	003553-001	003553-001
17	Eyebolt.....	2	065433-401	065433-401	065433-005
18	Flange, Packing Gland.....	1	010171-001
19	Flange, Temperature Well Plug.....	1	011941-001	011941-001	012026-001
20	Gasket	1	060341-001	060341-001	060341-001
21	Gasket, Cover Plate.....	1	003834-001	003834-001	003834-001
22	+ Gasket, Packing Gland	1	010173-001
23	@2+ Gear, Calibrator Drive:				
	U.S. Barrels, Standard and All Iron	1	513059-001	513059-001	513059-001
	U.S. Barrels, LPG	1	513059-001	515165-001	515165-001
	Imperial Gallons, Standard and All Iron	1	518440-001	518440-001	518440-001
	Imperial Gallons, LPG.....	1	518440-001	518457-001	518457-001
	Hectolitres, Standard and All Iron	1	514803-001	514803-001	514803-001
	Hectolitres, LPG.....	1	514803-001	515172-001	515172-001
24	Bushing:				
	Standard and All Iron	1	013372-001	013372-001	013372-001
	LPG.....	1	013372-001	504653-001	504653-001
25	Pin	2	003325-001	003325-001	003325-001
26	@2+ Gear, Intermediate Pinion:				
	U.S. Barrels, Standard and All Iron	1	518443-001	514813-001	514813-001
	U.S. Barrels, LPG	1	518443-001	515164-001	515164-001
	Imperial Gallons, Standard and All Iron	1	518437-001	518436-001	518436-001
	Imperial Gallons, LPG.....	1	518437-001	518456-001	518456-001
	Hectolitres, Standard and All Iron	1	518441-001	514814-001	514814-001
	Hectolitres, LPG.....	1	518441-001	515171-001	515171-001
27	Bushing, LPG Only	1	504653-001	504653-001
28	Pin	2	001126-001
29	@2+ Gear, Jackshaft Pinion:				
	Standard and All Iron (All).....	1	518442-001	514806-001	514806-001
	LPG (All).....	1	518442-001	515163-001	515163-001
30	Bushing, LPG Only	1	504653-001	504653-001
31	Pin	2	001126-001

Item		Description	Qty.	H8-S1	H8-S3, S5	H8-S6, S7
32	+@3	Gland, Packing:				
	R	Buna-N.....	1	518630-001	513644-001	515849-001
	R	Viton	1	518630-002
		Teflon.....	1	009535-001	513644-002	515849-002
		Brass.....	1	008934-002
		NACE.....	1	551728-001	551178-001
33		Housing, Gear:				
		Standard and All Iron	1	514625-001	514625-001
		LPG.....	1	514625-002	514625-002
34		Bushing:				
		Standard and All Iron	1	519882-001	519882-001
		LPG.....	1	514835-001	514835-001
35		Dowel.....	1	003628-001	003628-001
36		Housing, Outer:				
		S1, S3, S6 (Standard).....	1	513082-001	513082-001	515915-001
		S5, S7 (Standard)	1	513102-001	515923-001
		S1, S3 NACE	1	551656-001	551656-001
37		Lubrication Assembly.....	1	514659-001
38		Fitting, Grease.....	1	006408-001
39		Nipple.....	1	641111-404
40		Nut:				
		S1, S6	26	642138-406	640261-001
		S3, S5	26	642138-406
		S7.....	48	640976-402
41	+	O-Ring, Cover:				
		Buna-N, S7 Only	1	516049-001
		Buna-N, All Others	1	512940-001	512940-001	516048-001
		Viton, S7 Only	1	516049-002
		Viton, All Others	1	512940-002	512940-002	516048-002
		EPR.....	1	512940-003	512940-003
		Teflon.....	1	643828-409	643828-409
42	+	O-Ring, Packing Gland:				
		Buna-N.....	1	640173-023	640888-001
		Viton	1	640894-403	640894-001
		EPR.....	1	641560-408	641560-401
		Teflon.....	1	641754-407	641754-409
43		Oiler	1	006588-001	006588-001	006588-001
44		Pin, Cotter.....	1	001095-401	009825-400	009825-400
45		Pin, Counter Drive Coupling, 1/16" x 5/8".....	1	006028-002	006028-002	006028-002
46		Pin, Groove, 1/16 x 1/2".....	1	006054-002	006054-002
47		Pin, Groove, 5/64 x 5/8".....	1	009593-400	009593-400
48		Pin, Groove, 3/16 x 3/8".....	2	641007-401
49		Pin, Input, Coupling	1	006053-002	006317-002	006053-002
50		Pin, Outer Cover:				
		S7 Only	1	641719-408
		All Others	1	640985-401	640985-401	641719-406
51		Plate, Caution	1	006571-001	006571-001	006571-001
52		Plate, Cover	1	003440-001	003440-001	003440-001
53	+	Plate, Thrust Bearing (See Item #90 for LPG Trim)	2	001111-001
54		Plug, Pipe:				
		1/8" NPT, Standard	1	006073-002	006073-002
		1/8" NPT, NACE	1	645242-405	645242-405
		1/4" NPT, Standard	1	006393-002
55		Plug, Pipe:				
		3/4" NPT, Standard	1	006878-002	006878-002
		3/4" NPT, NACE	1	645242-403	645242-403
		1" NPT, Standard	1	640977-402
56		Plug, Pipe, 1/2" NPT:				

Item	Description	Qty.	H8-S1	H8-S3, S5	H8-S6, S7
	Standard.....	1	006505-002	006505-002	006505-002
	NACE	1	645242-402	645242-402
57	Plug, Temperature Well.....	1	012025-001	012025-001	012025-001
58	+ Retainer, Ball (Not Used With LPG Trim)	1	070360-001
59	Ring, Snap	1	512066-001	512066-001	512066-001
60	Screw, #6-32 x 5/16".....	2	006048-002	006048-002	006048-002
61	Screw, #10-24 x 3/4", Drilled	2	006481-003	006481-003	006481-003
62	Screw, #10-32 x 3/8".....	2	006045-002	006045-002	006045-002
63	Screw, #10-32 x 7/8".....	2	640835-001	640835-001	640835-001
64	Screw, Adapter to Cover, Drilled.....	2	642019-416	009548-400	642019-416
65	Screw, Gear Housing, 5/16-18 x 5/8".....	2	009813-400	009813-400
66	Screw, Packing Gland:				
	S1, #10-32 x 1/2"	2	006764-002
	S3, S5, 5/16-18 x 1-1/4".....	2	006511-002
	S6, S7, 7/16-14 x 1-1/2".....	4	006410-002
67	Screw, Cap:				
	S1, S3, S5 Standard, 3/4-10 x 2"	4	641068-401	641068-401
	S1, S3, S5 NACE	4	645329-402	645329-402
	S6, S7 Standard, 3/4-10 x 2-1/2"	4	641068-406
68	Screw, Cap:				
	S6 Only, 1-8 x 6"	24	642226-405
	S1, S3, S5, 3/4-10 x 3".....	24	641068-403	641068-403
69	Screw, Drive.....	8	009880-400	009880-400	009880-400
70	Screw, Set, #10-32 x 1/4"	1	009469-400	009469-400
71	Screw, Temperature Well	2	060133-002	006035-002	006409-002
72	+ Seal, Lead, and Wire	3	001627-400	001627-400	001627-400
73	Shaft, Calibrator Drive Gear	1	515341-001	515341-001
74	Shaft, Jack-Upper	1	512116-002	514634-002	514634-002
75	Shaft, Link Assembly	1	512069-001	515346-001	515866-001
76	Pin, Groove, 1/8 x 1"	2	065217-402	065217-402	065217-402
77	Stem Assembly, Adjusting	1	009838-001	009838-001	009838-001
78	Ball	2	006427-001	006427-001	006427-001
79	Plate, Base.....	1	003552-001	003552-001	003552-001
80	Plate, Retainer	1	003556-001	003556-001	003556-001
81	Spring, Knob	2	003557-001	003557-001	003557-001
82	Stem, Adjusting.....	1	003551-001	003551-001	003551-001
83	Stud, S7 Only, 1-1/4-8 x 9-1/2"	24	642355-404
84	Stud, Gear Shaft.....	1	514370-001	514370-001
85	Tube, Oil.....	1	514658-001	514658-001	514658-001
86	Washer	3	641985-402	641985-402
87	Washer	4	642495-407	642495-407	533104-001
88	Washer, Pinion Shaft	1	003599-001
89	+ Washer, Jackshaft.....	1	001125-001
90	Washer, Thrust - Jackshaft, LPG Only.....	2	505664-001

Inner Mechanism

Item	Description	Qty.	Part Number
91	Block:		
	Standard.....	1	513033-001
	Hi-Viscosity - For 2,000 SSU to 10,000 SSU	1	513033-041
92	Body.....	1	513009-001
93	Coupling, Drive	1	512064-002
94	Cover, Inner:		
	Standard and All Iron	1	516458-001
	LPG	1	516458-002
95	+ Bushing, Jackshaft:		
	Standard and All Iron	2	519882-001
	LPG.....	2	512796-001

Item	Description	Qty.	Part Number
96	Dowel, Locating Arm.....	1	512938-001
97	Lug, Lift.....	2	512002-002
98	Nut, 7/16"-20.....	2	010526-400
99	Nut, Inner Cover	1	009552-400
100	Pin, Groove, 1/4 x 1"	1	641065-401
101	Pin, Roll, 5/32 x 1"	1	010527-400
102	Pin, Roll, 1/16 x 1/2"	1	009593-400
103	Pitot.....	1	072186-001
104	@6 Plate, Lock, Rotor Adjustment	1
105	Plate, Shaft Cover.....	1	512939-001
106	Ring, Retaining	1	640968-407
107	Rotor and Blade Assembly:		
	Standard.....	1	515708-001
	All Iron	1	515708-002
	LPG	1	515708-003
108	Arm, Locating	1	512923-001
109	Bar, Adjusting	1	512936-001
110	+ Bearing, Lower Rotor:		
	Standard and All Iron	1	516605-001
	LPG.....	1	516605-004
111	+ Bearing, Upper Rotor:		
	Standard and All Iron	1	513080-001
	LPG.....	1	513080-002
112	+ Bearing, Thrust:		
	Standard and All Iron	1	641093-401
	LPG.....	1	643140-401
113	+ Blade, Lower:		
	Standard	1	512920-001
	All Iron.....	1	515417-001
	LPG.....	1	515419-001
	Std. - Modified for 2,000 SSU to 10,000 SSU	1	512920-041
	Std. - Modified for 200°F Max.....	1	512920-042
	Std. - Modified for 2,000 SSU to 10,000 SSU and 200°F Max.....	1	512920-043
	A.I. - Modified for 2,000 SSU to 10,000 SSU	1	515417-041
114	+ Blade, Upper:		
	Standard	1	512921-001
	All Iron.....	1	515416-001
	LPG.....	1	515418-001
	Std. - Modified for 2,000 SSU to 10,000 SSU	1	512921-041
	Std. - Modified for 200°F Max.....	1	512921-042
	Std. - Modified for 2,000 SSU to 10,000 SSU and 200°F Max.....	1	512921-043
	A.I. - Modified for 2,000 SSU to 10,000 SSU	1	515416-041
115	+ Bearing, Blade:		
	Standard and All Iron:		
	@4 Current Design	4	644888-401
	Previous Design	4	006476-001
	LPG:		
	@4 Current Design	4	644412-411
	Previous Design	4	644412-404
116	@4 Bushing (Previous Design Bearing Only)	2	512353-001
117	Pin, Cotter, 3/32 x 1"	2	006308-001
118	Shaft, Bearing	2	500214-001
119	Spacer (Current Design Bearing Only).....	6	504272-002
120	Clamp, Rotor Cover Roller.....	8	500414-001
121	Collar, Adjusting.....	1	513093-001
122	Pin, Adjusting Collar.....	1	006683-002
123	Key, Locating Arm.....	1	513094-001
124	Pin, Rotor Cover Roller.....	4	512998-001

Item	Description	Qty.	Part Number
125	Plate, Rotor Bearing	2	513065-001
126	Plate, Rotor Gear.....	1	512924-001
127	+ Roller	4	513000-001
128	Rotor:		
	Standard	1	513003-001
	Hi-Viscosity - For 2,000 SSU to 10,000 SSU.....	1	513003-041
	Hi-Temperature - For 200°F Max.....	1	513003-042
	Hi-Visc./Hi-Temp. - For 2,000 SSU to 10,000 SSU & 200°F Max...	1	513003-043
129	Dowel	9	500415-001
130	Screw, Cap, 5/16-18 x 1-1/2":		
	Standard and LPG	8	002050-401
	All Iron.....	8	642043-432
131	Sleeve, Rotor.....	2	512999-001
133	Screw, Locating Arm, 5/16-24 x 1-1/4"	1	643299-401
134	Screw, Rotor Gear Plate, 5/16-18 x 1"	6	060133-002
135	Shaft and Cam Assembly	1	513066-001
136	+ Cam.....	1	512510-001
137	Key, Locating Arm	1	513064-001
138	Shaft.....	1	513061-001
139	Screw, #10-32 x 1/4"	2	006110-002
140	Screw, Cap-Block, 1/2-13 x 1-1/2"	2	006097-002
141	Screw, Cap-Inner Cover, 5/16-18 x 2"	1	006664-002
142	Screw, Inner Cover, 1/4-20 x 1/2"	1	006775-002
143	Screw, Inner Cover to Body, 3/8-16 x 1-1/4"	8	660248-402
144	@5 Screw, Lower Bearing Plate, 5/16-18 x 3/4"	12	009548-400
145	Screw, Nylock, 1/2-13 x 1-1/2"	1	641066-401
146	Shaft, Jack and Gear	1	512931-001
147	Stem, Rotor Adjusting.....	1	550857-001
148	@5 Washer	2	641838-401
149	Washer	1	643249-401
150	Washer, Shakeproof	1	006825-400

Inner Mechanism General Assemblies

Standard	513134-091
All Iron.....	513134-092
LPG.....	513134-093

+ Recommended stock.

R Indicates change since last revision.

@1 Note 1: When ordering, include temperature range, specific API Gravity, and API table used.

@2 Note 2: Only standard gearing is listed. For additional gearing combinations, see Gear Train Bulletin SS01027.

@3 Note 3: See Form No. P0605.* for components.

@4 Note 4: Use of current design bearing eliminates the need to use bushing (Item 116) which was required with the previous design bearing; however, it requires the use of a spacer (Item 119) on the side of and between the bearings.

@5 Note 5: Item 144 screw and Item 148 washer were incorporated into the meter in 1984. These items are not included in meters manufactured prior to 1984.

@6 Note 6: Replace Rotor Adjustment Lock Plate, P/N 513092-001 with the following:

Qty. 2 - Nut, P/N 010526-400 (Item 98)

Qty. 1 - Rotor Adjusting Rod, P/N 550857-001 (Item 147)

Qty. 1 - Pin, P/N 010527-400 (Item 101)

* The latest edition is indicated by a 2-digit postscript (e.g., .01, .02, etc.).

The specifications contained herein are subject to change without notice and any user of said specifications should verify from the manufacturer that the specifications are currently in effect. Otherwise, the manufacturer assumes no responsibility for the use of specifications which may have been changed and are no longer in effect.

Headquarters:

1803 Gears Road, Houston, TX 77067 USA, Phone: 281/260-2190, Fax: 281/260-2191

Gas Measurement Products:

Erie, PA USA Phone 814/898-5000

Thetford, England Phone (44) 1842-82-2900

Kongsberg, Norway Phone (47) 32/286-700

Buenos Aires, Argentina Phone 54 (11) 4312-4736

Gas Measurement Products:

Houston, TX USA Phone 281/260-2190

Thetford, England Phone (44) 1842-82-2900

Kongsberg, Norway Phone (47) 32/286-700

Buenos Aires, Argentina Phone 54 (11) 4312-4736

San Juan, Puerto Rico Phone 787/274-3760

United Arab Emirates, Dubai Phone 971 +4/331-3646

Integrated Measurement Systems:

Corpus Christi, TX USA Phone 361/289-3400

Kongsberg, Norway Phone (47) 32/286-700

San Juan, Puerto Rico Phone 787/274-3760

United Arab Emirates, Dubai Phone 971 +4/331-3646

Integrated Measurement Systems:

Corpus Christi, TX USA Phone 361/289-3400

Kongsberg, Norway Phone (47) 32/286-700

Visit our website at www.fmctechnologies.com