



MeasureMaster Dual Chamber Orifice Fitting

Contents

| | |
|---|---|
| Retro Fit Instructions – Removing the Grease Plug Valve..... | 2 |
| Retro Fit Instructions – Installation of the Dry Seal Plug Valve..... | 3 |

Retro Fit Instructions – Removing The Grease Plug Valve

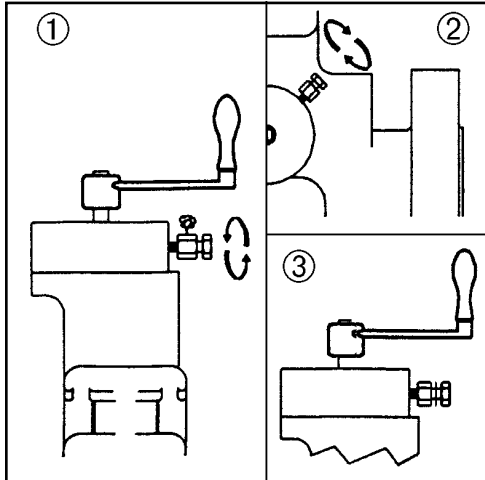

Removal Of Grease Type Plug Valve

NOTE: FMC Measurement Solutions MeasureMaster Plug Valves cannot be removed or repaired while the fitting is in service. All internal pressure in the fitting and pipe line must be reduced to atmospheric pressure before attempting to remove the plug valve or the front or the back plug valve caps.

1. Open bleed valve by turning stem counter-clockwise. (See illustration #1.)
2. Open equalizer valve by turning stem counter-clockwise. (See illustration #2.)

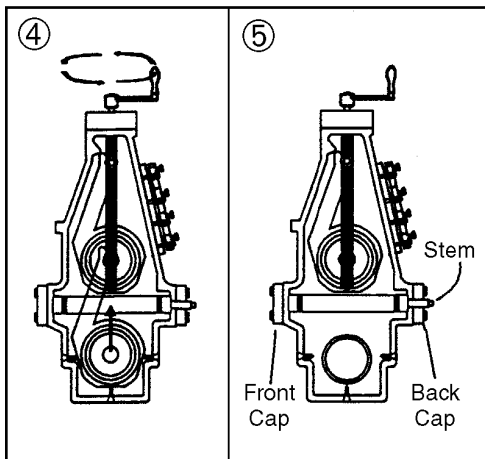

3. No gas should be escaping from the bleed valve. SEE NOTE ABOVE. (See illustration #3.)
4. Rotate the elevator screw handle in a counter-clockwise direction until the carrier is lifted into the upper chamber and comes to a full stop. (See illustration #4.) COUNT NUMBER OF TURNS AS SHOWN ON NAME PLATE.
5. Remove the front and back plug valve end caps. Retain the end cap bolts for use with the new Dry Seal Plug Valve. (See illustration #5.)
6. Remove the plug valve stem and spacers, if necessary.

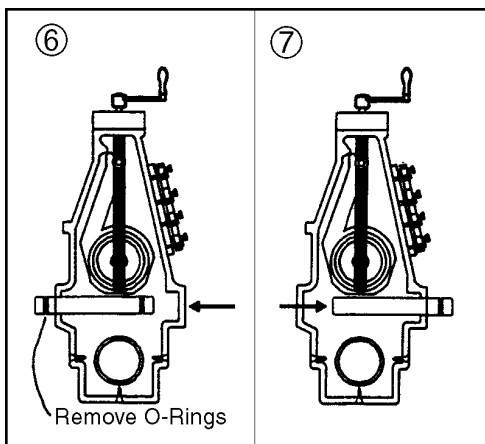

7. Using a wood block, drive the plug valve towards the back cap side of the plug valve bore far enough to remove the plug valve O-rings and remove the O-rings. Take care not to damage the surfaces in the plug valve bore. (See illustration #6.)
8. Using the wood block, drive the plug valve back towards the front cap side of the plug valve bore and remove the plug valve completely from the fitting. (See illustration #7.)

Retro Fit Instructions – Installation Of The Dry Seal Plug Valve

Installation Of Dry Seal Plug Valve

1. Clean parts of any metal chips or other debris.
2. Note: Front cap can be identified by the presence of 5/8" spot faces for equalizer O-rings.
3. Place cap O-rings in proper O-ring grooves on front and back caps. Grease may be used to retain O-rings in caps.
4. Place O-ring in plug valve O-ring groove. Use grease to prevent damage to O-ring.
5. Place plug valve into plug valve bore. Stop pin relief goes towards front cap end. **(See illustration #1 & #2.)**
6. Assemble front cap over valve shaft and install front cap bolts. "Closed" stamped on the front cap goes toward the top of fitting. Make sure that lip on cap face is not damaged during assembly. This lip is used to properly center and locate cap in plug valve bore. **(See illustration #3.)**
7. Note: Spacer washers may be required on BACK cap end shaft. Use enough washers to limit end play to less than .125". **(See illustration #5.)** SPACER WASHERS ARE NEVER USED ON THE FRONT CAP END SHAFT.
8. Assemble back end cap to valve shaft and fitting body. "Closed" stamped on the back cap goes toward the top of the fitting. Make sure that lip on cap face is not damaged during assembly. This lip is used to properly center and locate cap in plug valve bore.
9. After caps are properly seated, tighten cap bolts as needed.
10. Check that plug valve end play is less than .125". **(See illustration #5.)**
11. Verify correct operation of fitting using MeasureMaster Dual Chamber Orifice Fitting with Dry Seal Plug Valve OPERATION INSTRUCTIONS (MNOR001).

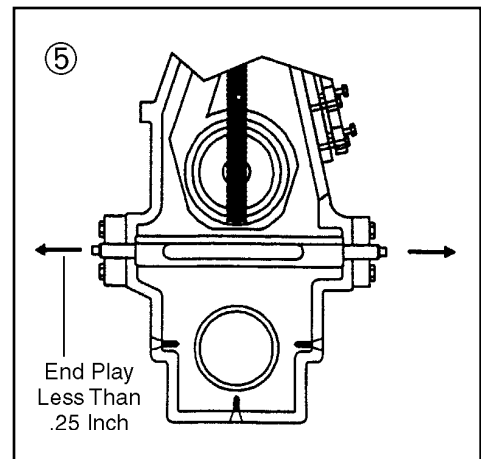
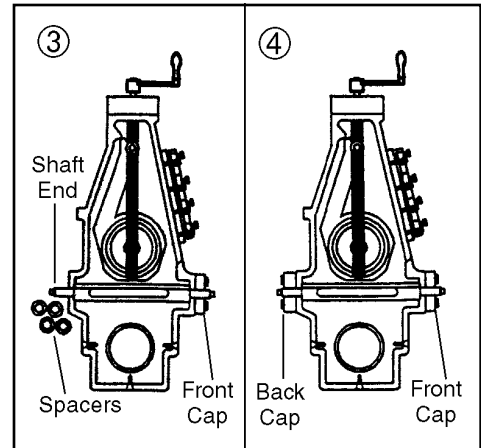
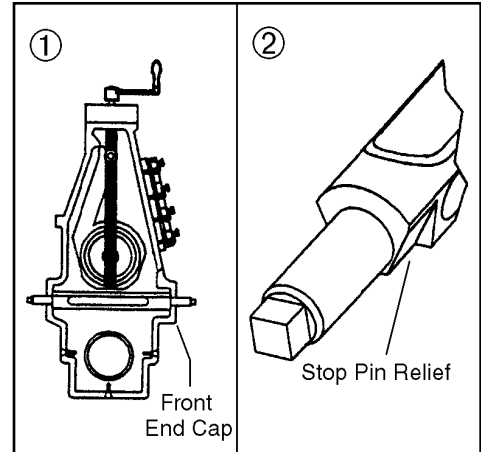

Bleed Valve Caution Tag

⚠ As a safety precaution, FMC Measurement Solutions recommends that the bleed valve be piped to a safe, outside area if this equipment is installed inside buildings or enclosures.

The specifications contained herein are subject to change without notice and any user of said specifications should verify from the manufacturer that the specifications are currently in effect. Otherwise, the manufacturer assumes no responsibility for the use of specifications which may have been changed and are no longer in effect.

Headquarters:

1803 Gears Road, Houston, TX 77067 USA, Phone: 281/260-2190, Fax: 281/260-2191

Gas Measurement Products:

Houston, TX USA Phone 281/260-2190
Thetford, England Phone (44) 1842-82-2900
Kongsberg, Norway Phone (47) 32/286-700
Buenos Aires, Argentina Phone 54 (11) 4312-4736

Integrated Measurement Systems:

Corpus Christi, TX USA Phone 361/289-3400
Kongsberg, Norway Phone (47) 32/286-700
San Juan, Puerto Rico Phone 787/274-3760
United Arab Emirates, Dubai Phone 971 +4/331-3646

Liquid Measurement Products:

Erie, PA USA Phone 814/898-5000
Longmont, CO USA Phone 303/702-7400
Los Angeles, CA USA Phone 661/296-7711
Slough, England Phone (44) 1753-57-1515
Ellerbek, Germany Phone (49) 4101-3040
Barcelona, Spain Phone (34) 93/201-0989
Moscow, Russia Phone (7) 495/564-8705

Melbourne, Australia Phone (61) 3/9807-2818
Beijing, China Phone (86) 10/6500-2251
Singapore Phone (65) 6861-3011
Chennai, India Phone (91) 44/450-4400

Visit our website at www.fmctechnologies.com