

Parts List

Technical Manual
8-019
Issued: 2/98
Supersedes: 7/96
Rev. D

251294

METER PRINTER

ACCUMULATIVE
(NONRESET)
TYPE

SERIES
788801

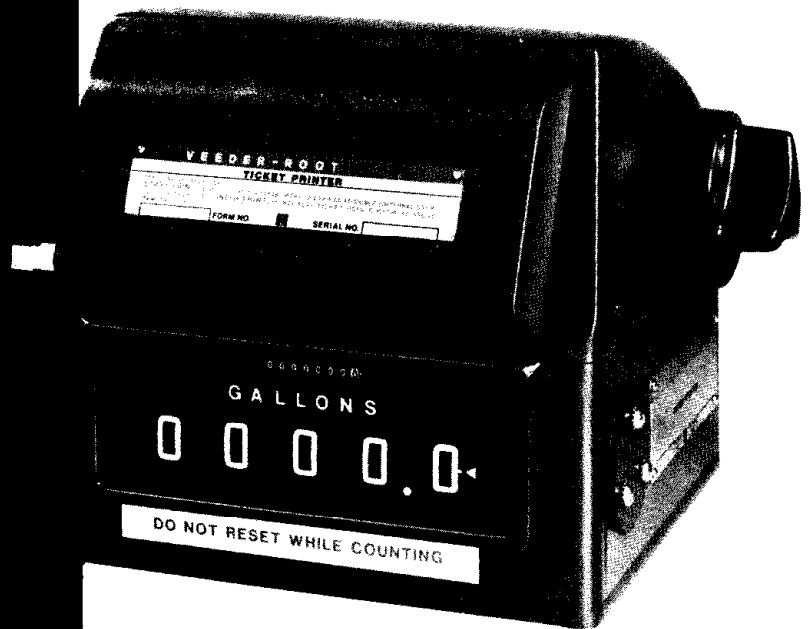

VEEDER-ROOT 
Petroleum Products

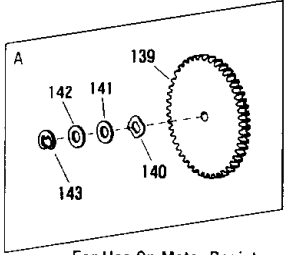
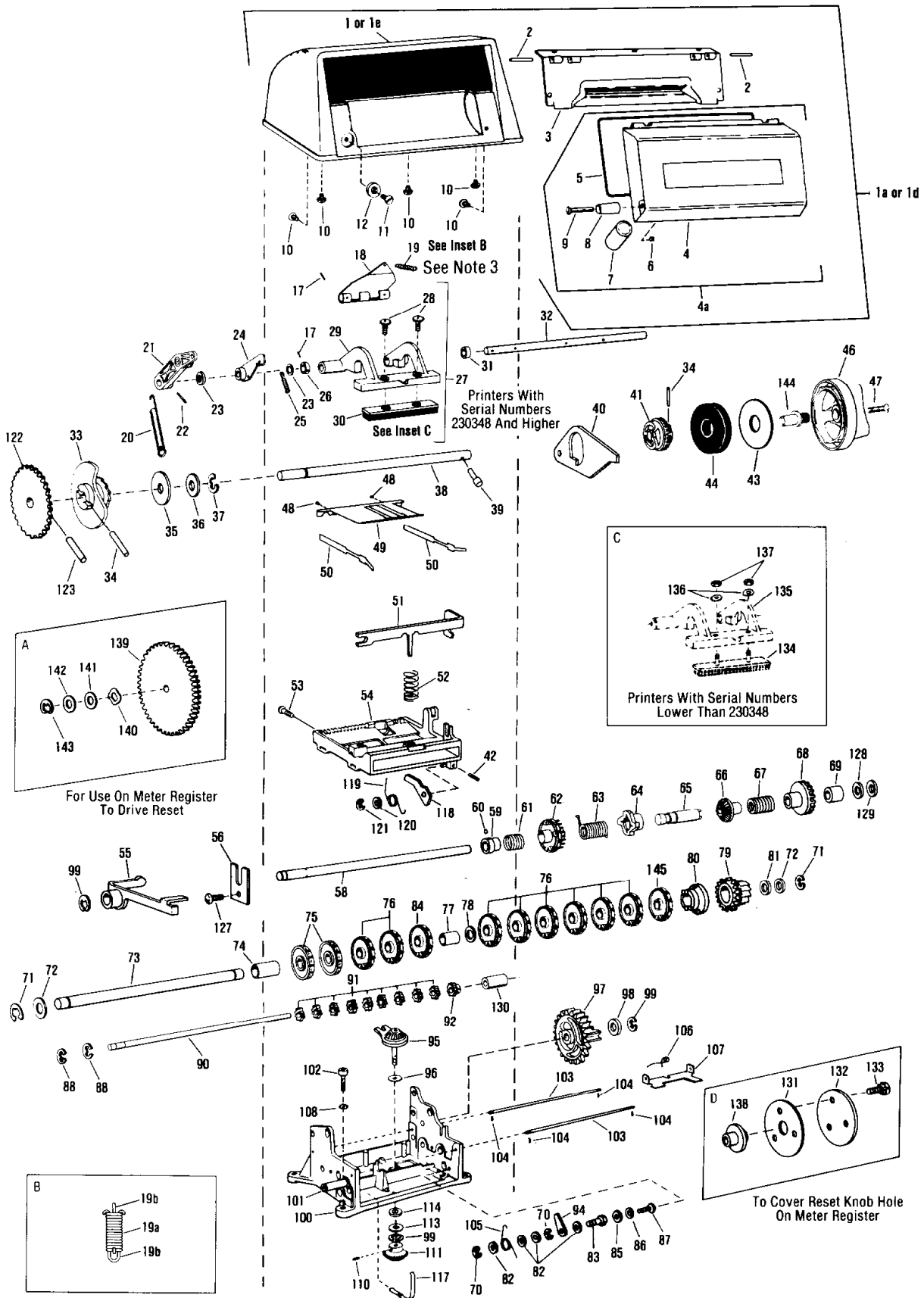

For Use On Meter Register To Drive Reset

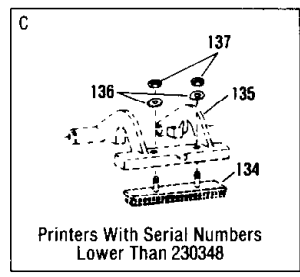
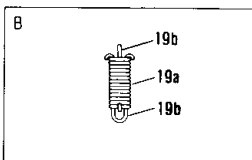

Printers With Serial Numbers Lower Than 230348

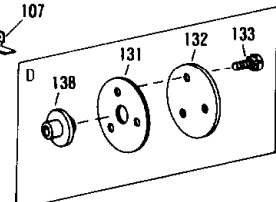

To Cover Reset Knob Hole On Meter Register

Printers With Serial Numbers 230348 And Higher
See Inset C

See Inset B
See Note 3

Meter Duplicator
Accumulative (Nonreset) Type

ITEM NO.	PART NO.	PART NAME	QUANTITY PER UNIT
1	80548-1-011	Cover Housing-Self Closing	1
1a	80601-1-018	Cover Assembly-Self Closing (Items 1-12 Inclusive)	1
	See NOTE 4		
1d	80601-4-030	Cover Assembly-Self Closing (Left Hand)	1
1e	80548-4-020	Cover Housing-Self Closing (Left Hand)	1
2	14154-JH-510	Pin	2
3	80549-1-010	Ticket Guide	1
4	80603-1-010	Ticket Cover	1
4a	80444-1-008	Ticket Cover Assembly (Items 4-7 Inclusive)	1
5	80395-6-030	Gasket	1
6	502241-001	Set Screw (#8-32 x 3/16")	1
7	80396-1-005	Magnet	1
8	80242-1-005	Knob	1
9	502259-003	Screw (#8-32 x 1")	1
10	510500-116	Screw (#5-40 x 7/32")	5
11	501513-009	Screw (#5-40 x 3/8")	1
12	80446-1-005	Magnet Plate	1
13	Not Used		
14	Not Used		
15	Not Used		
16	Not Used		
17	510163-001	Groove Pin (3/32" x 1/2")	3
18	32636-D-025	Rebound Plate	1
19a	310325-334	Spring-Compression	1
19b	328158-001	Spring-Loop	2
20	14427-QE-790	Printing Arm Lever Spring	1
21	G327582-001	Printing Arm	1
22	510125-001	Groove Pin (3/32" x 11/16")	1
23	11071-FA-299	Washer	As Req'd.
24	323992-001	Pawl Group	1
25	51488-011	No-Back Pawl Spring	1
26	874201-114	Collar	1
27	G32629-24-338	Printing Arm (Includes 28, 29, 30)	1
28	511850-179	Screw #10-32	2
29	328044-001	Printing Arm	1
30	313500-031	Printing Arm Cushion	1
31	884009-026	Spacer	1
32	32774-B-011	Shaft	1
33	320591-001	Cam Group, Printing Arm	1
34	512900-239	Spiral Pin	2
35	33753-F-040	Washer .020"	1
36	11071-CK-150	Washer	As Req'd.
37	511816-001	Ring Retaining	1
38	324723-001	Shaft	1
	326157-001	Shaft (For Left Reset)	1
39	41603-CB-148	Stud	1
40	320519-001	Lever Tray, Actuating	1
41	320518-001	Gear Driver	1
42	501700-132	Screw, Set	1
43	74800-70-181	Washer	1
44	74800-42-125	Rubber Washer	1
45	Not Used		
46	324757-001	Knob (Left or Right)	1
47	502300-108	Flat Head Screw (8-36 x 2-1/4")	1
	502300-109	Flat Head Screw (8-36 x 1-3/4") (For Left Reset)	1
48	510500-431	Screw (4-40 x 1/4")	2
49	32729-14-121	Sales Slip Shield	1
50	313705-010	Ticket Guides	2
51	320520-001	Lever Seal	1
52	310325-305	Spring	1
53	510904-509	Screw (6-32 x 7/8")	1
54	323858-001	Tray Group (Includes 42, 48, 49, 50, 53, 118, 119, 120 & 121)	1
55	313420-012	Lever Group	1
56	325309-001	Clamp	1
58	320596-002	Shaft Clutch	1
59	313422-010	Retainer	1
60	501558-001	Set Screw	1
61	310340-320	Spring Clutch	1
62	323519-001	Disc, Transfer	1
63	310340-588	Spring Clutch	1
64	323518-001	Clutch Detent	1
65	313421-023	Driver	1
66	320610-002	Gear, Bevel	1
67	310340-494	Spring Clutch	1
68	320515-002	Gear, Clutch	1

ITEM NO.	PART NO.	PART NAME	QUANTITY PER UNIT
69	14614-BE-116	Spacer	1
70	511831-001	Ring, Retaining	2
71	511816-001	Ring, Retaining	2
72	11071-150	Washer	2
73	313371-010	Shaft, Wheel	1
74	884007-410	Spacer	1
75	317897-001	Wheel, Identifier	2
76	32838-41-215	Wheel, Printing	8
77	36967-005	Spacer	1
78	74800-108-258	Washer, 0.031"	As Req'd.
	74800-095-232	Washer, 0.015"	As Req'd.
	74800-60-161	Washer, 0.005"	As Req'd.
	11071-CK-161	Washer, 0.010"	As Req'd.
79	320513-001	Gear, Drive	1
80	324372-001	Coupling	1
81	11071-CK-161	Washer, 0.010"	1
82	74800-12-036	Washer, Flat	4
83	877040-650	Stud, Pawl	1
84	322825-002	Wheel, Print	1
85	110171-E-476	Washer	1
86	510055-030	Washer, Lock	1
87	850849-001	Screw, RD-HD #2-56 x 3/8"	1
88	511807-001	Retaining Ring,	2
89	Not Used		
	Not Used		
	Not Used		
90	320614-001	Shaft, Pinion	1
91	32812-24-160	Transfer Pinion	9
92	32812-22-150	Pinion, Drive	1
93	Not Used		
94	324371-001	Pawl, Ratchet	1
95	51429-9-045	Clutch Group Drive	1
96	74800-62-165	Washer	1
97	320535-001	Gear	1
98	11071-146	Washer	1
99	511810-001	Retaining Ring	3
100	321057-001	Frame Group (Includes 101 & 117)	1
101	32839-H-040	Print Arm Spring Pin	1
102	503641-005	Screw 1/4-28 x 3/4"	4
103	321055-001	Rod Tray Support	2
104	33834-A-011	Clip	4
105	310340-576	Spring, Pawl	1
106	310340-301	Spring Detent	1
107	313412-011	Detent	1
108	510003-006	Lock Washer	4
109	Not Used		
110	502225-001	Set Screw, 8-32 x 1/4"	1
111	70822-2-010	Bevel Gear	1
113	11071-CC-146	Washer	As Req'd.
114	11071-DF-205	Washer, 0.005"	As Req'd.
117	310340-478	Detent	1
118	320516-001	Pawl, Wheel Aligning	1
119	310340-568	Spring, Wheel Aligning Pawl	1
120	11071-DO-227	Washer	2
121	511809-001	Ring, Retaining	1
122	403071-352	Gear	1
123	510187-001	Pin, Groove	1
124	Not Used		
125	Not Used		
126	Not Used		
127	510500-431	Screw #4-40 x 1/4"	1
128	11071-DF-205	Washer	As Req'd.
129	11071-CC-146	Washer	As Req'd.
130	884009-144	Spacer	1
131	76124-1-005	Gasket	1
132	324718-001	Cover-Side, Register	1
133	510500-456	Screw	3
134	See NOTE 1	Printing Arm Cushion	1
135	See NOTE 1	Printing Arm	1
136	510002-001	Lock Washer	2
137	511013-002	Nut-Hexagon	2
138	325894-001	Security Plug	1
139	403071-420	Gear, Idler	1
140	885005-937	Washer-Wave Spring	1
141	885005-789	Washer	As Req'd.
142	885005-791	Washer	As Req'd.
143	511800-106	Retaining Ring	1
144	328741-001	Shaft - Right Reset	1
	328741-002	Shaft - Left Reset	1
145	322825-002	Wheel - Print, Rt (0-9)	1
	320511-007	Wheel Grp.-Print, Rt (0-9) See NOTE 2	1

NOTE 1: Part no longer available, replace with Item No. 27 -G32629-24-338.

NOTE 2: When Item No. 145 is Part No. 320511-007, **NO NOT USE** Item No. 80, Part No. 324372-001 and use As Req'd washer 11071-DC-199 in place of Item No. 81.

NOTE 3: Part no longer available, replace with two Item 19b No. 328158-001 Spring Loops and one Item 19a No. 310325-334 Compression Spring and assemble per Inset B.

NOTE 4: Sheet Metal Cover design no longer available, use Self-Closing design.



6th Avenue at Burns Crossing, P.O. Box 1673, Altoona, PA 16603-1673 Phone (814) 695-4476, or (800) 873-3313, Fax (814) 695-7605, or (800) 234-5350

BRAZIL: Sao Paulo • CANADA: Mississauga, Ontario • ENGLAND: Richmond Surrey • FRANCE: Aulnay-Sous-Bois • GERMANY: Aldingen • SINGAPORE: Singapore

Part # 251294, Rev. D, 13280 Replaces 12531

VC 2 ^{PRINTED}
_{IN}
U.S.A. 98