

Versenkte Schraube zum versiegeln
Recessed screw for sealing

M16x1.5, Ex e, M12x1.5, Ex e,

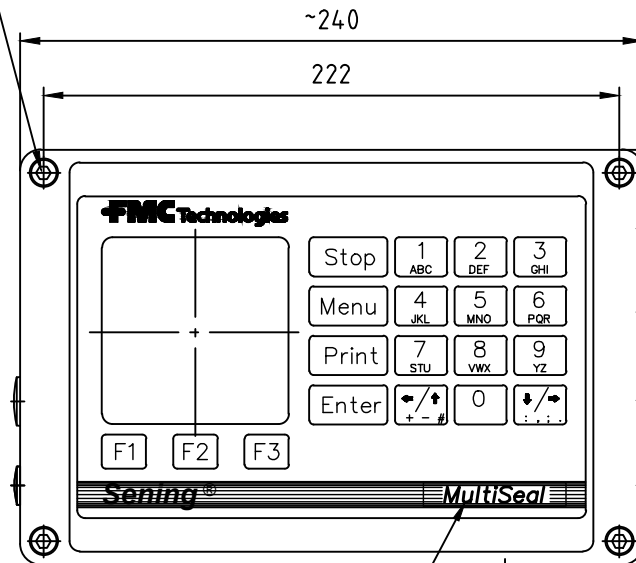

Namensstreifen MultiSeal
Name stripe MultiSeal

M16x1.5, Ex e,
schwarz / black
Ø6-10mm

M16x1.5, Ex e,
schwarz / black
Ø5-8mm

M16x1.5, Ex e,
EMV / EMC Type
Ø5-8mm

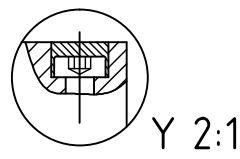
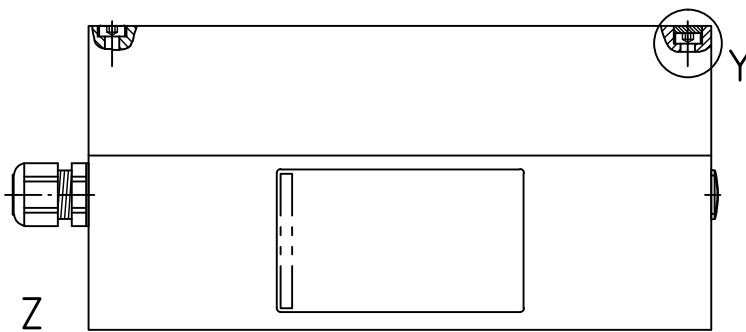

EPROM programmiert mit aktueller Software Version
EPROM programmed with actual software version

2	352033	1	Gehäuse-Unterteil	Housing-bottom part
1	351930	1	Gehäuse-Oberteil	Housing-top part
Pos./Item	Teile-Nr./Part-No.	Stück/Quant.	Benennung	Description

MultiSeal
Main Unit & Display
komplett / complete

FMC Technologies

F.A. Sening GmbH
D-25474 Ellerbek, Germany

Weight : 4,3 kg Date : 14.03.2007 Name : Larsen

Part-No. MSMAINDISP2

Changed: ECN No. 20734	Date: 29.09.09	Name: RL	Drawing No.: 51.352024	Rev. D
	08.07.11	RL		
	23.02.12	RL		